

## TROUBLESHOOTING GUIDE

**Note :** In case the following measures do not work, please take the Mixer Grinder to the nearest Authorized Service Centre.

PROBLEM	CAUSE	CORRECTIVE ACTION
The Mixer does not start	No power supply	Ensure Power Supply
	Tripped due to overload	Switch off the power supply. Remove excess load and reset the OLP located at the bottom of the mixer base. (If it still does not work, contact the nearest Eveready Service Centre).
	Overloading	Fill the Chutney Jar up to the level of blades & the other 2 jars up to the capacity level indicated.
The result/performance is not satisfactory	Size of ingredients is not proper	Cut/Break down the ingredients to be ground into appropriate size.
	Wrong Jar/Blade used	Ensure that you are using the jar / blade for its right / intended purpose.
Mixer generates abnormal noise	Jar is not locked properly	Lock the Jar properly.
	Blade assembly loosen up	Tighten the dome nut of the blade assembly properly.
	Coupler is loosen up	Tighten the Coupler.

**EVEREADY** >>>  
INDUSTRIES INDIA LTD.

1, Middleton Street, Kolkata-700071, India  
Consumer Care - address as above - Ph. 1800-102-4041  
Email: appliancecare@eveready.co.in

# EVEREADY

## Appliances



# MIXER GRINDER



Sin750L

2 YEAR  
WARRANTY

5 YEAR  
WARRANTY  
ON MOTOR

750W

USER MANUAL

\* Images are only indicative.  
Actual product may differ from the one shown on the carton.

## IMPORTANT SAFEGUARDS

This product is designed and intended for household use only. Please read all the instructions carefully before using Eveready Sin750L Mixer Grinder. Even if you are familiar with the product then also place it handy for ready-reference.

1. Before plugging in ensure that the voltage specified on the rating label of your product corresponds to your house electricity supply voltage.
2. Do not immerse the appliance, power cord or plug in water or any other liquid.
3. Never operate the appliance unless jar and lid are secured in place and do not leave it unattended also.
4. Always keep the Mixer Grinder on a stable, firm and dry surface.
5. Do not operate the Mixer with an empty jar.
6. Jars provided with this Mixer Grinder should not be used for storage.
7. Keep the Mixer Grinder at least 6 inches away from the wall.
8. Do not touch moving parts and blades, when Mixer Grinder is in operation.
9. Do not operate the product when it is damaged or it does not work properly. Bring the product to the nearest Authorized Service Centre for testing, repair or adjustments to avoid any hazards.
10. Switch off and remove the plug from the power outlet when not in use, before assembling and disassembling parts, cleaning or carrying out any maintenance of the appliance.
11. When using extension cord with your product, make sure that the extension cord is correctly wired and rated for its use.
12. Do not leave the product unattended when it is connected to the main supply outlet.
13. Do not let the power cord hang over the edge of a table, counter or be in touch with hot surfaces.
14. When unattended and while fixing jars, in both cases ensure that the speed switch is in off position.
15. Keep the product out of reach of children at all times. Close supervision is necessary when used near children or by physically challenged persons or by people who lack experience to use the same appliance.
16. Never carry the product by the power cord or yank it to disconnect it from the outlet, instead grasp the plug and pull out to disconnect.
17. The use of attachment or accessories not recommended or sold by Eveready may result in fire, electric shock or personal injury.
18. To clean, wipe out the exterior with a damp cloth and handle blades carefully as they have sharp edges.
19. Do not operate or place any part of this product on or near any hot surface (such as gas or electric burner or in a heated oven).
20. Do not drop the main unit or jars.

## PARTS IDENTIFICATION

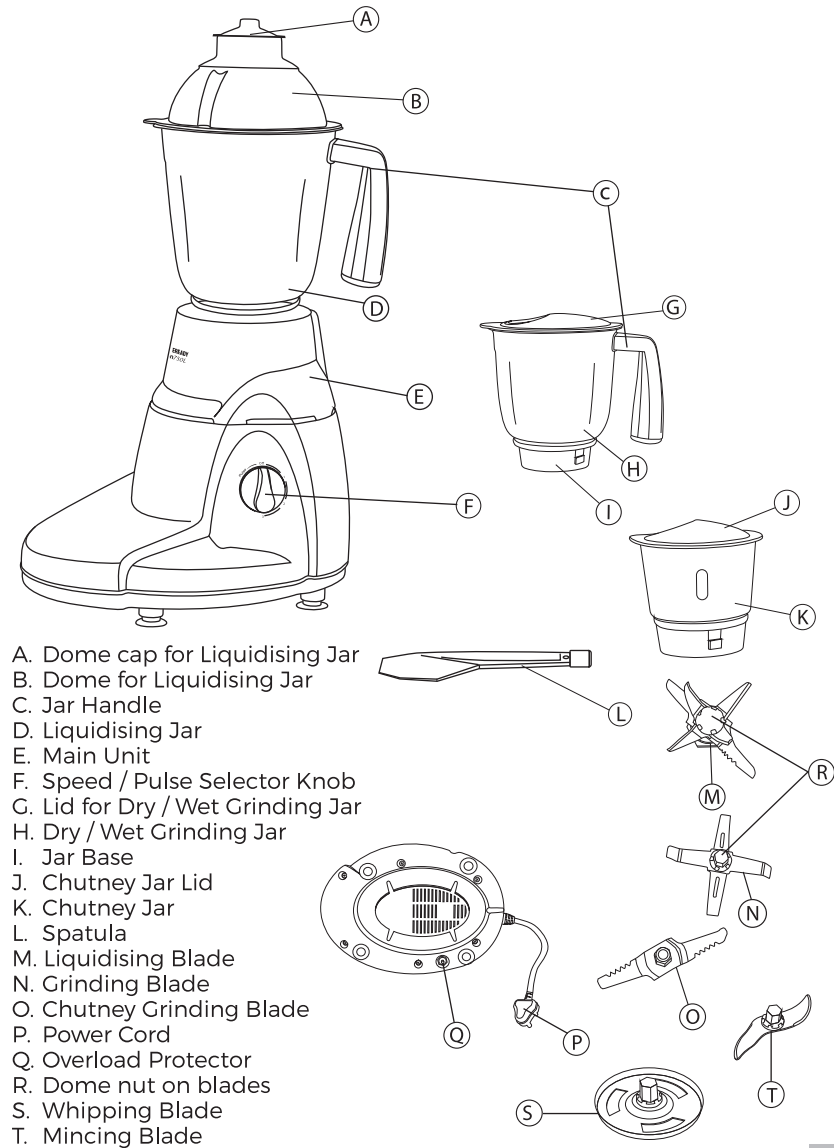

- A. Dome cap for Liquidising Jar
- B. Dome for Liquidising Jar
- C. Jar Handle
- D. Liquidising Jar
- E. Main Unit
- F. Speed / Pulse Selector Knob
- G. Lid for Dry / Wet Grinding Jar
- H. Dry / Wet Grinding Jar
- I. Jar Base
- J. Chutney Jar Lid
- K. Chutney Jar
- L. Spatula
- M. Liquidising Blade
- N. Grinding Blade
- O. Chutney Grinding Blade
- P. Power Cord
- Q. Overload Protector
- R. Dome nut on blades
- S. Whipping Blade
- T. Mincing Blade

## USING THE MIXER GRINDER

### Using the Mixer Grinder for the first time

Before you start the Mixer Grinder for the first time or after a long period of non-usage:

- Please rotate the motor shaft by hand to ensure that it turns freely & smoothly (Fig.2) Make sure that the unit is not connected to the power source
- Before fixing the jar to the main unit, rotate the jar coupler to ensure that it turns freely (Fig.3)
- Each jar comes fitted onto an aluminium base that has to be fitted onto the main unit. Hold the base and rest it on the main unit (Fig.4)
- Plug the main cord in the wall socket & switch the power ON

## ASSEMBLY

**Warning:** Make sure that the Mixer Grinder is switched off and unplugged.

1. Clean the Mixer Grinder attachments before using it for the first time with a damp cloth.
2. Insert the Mixer Grinder blades in the appropriate jar and turn until it locks into position, using the spatula.
3. Place the jar on the main unit through the jar base.
4. Put the ingredients to be processed in the jar.
5. Fix the appropriate jar lid firmly on the jar ensuring that the lid has been locked in securely from all side.
6. The Mixer Grinder can now be plugged in and is now ready to use.
7. Use speed control knob and move gradually from lower to higher speeds.
8. After use, unplug the Mixer Grinder.

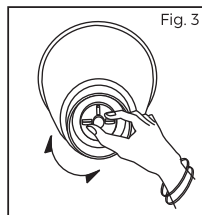
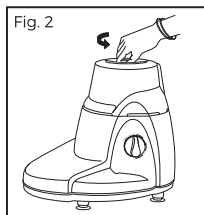

## BLENDING AND LIQUIDISING JAR

This jar can be used to perform all types of blending & liquidising operations such as preparation of Lassi, Milk Shakes, Purees, Juices, Idli / Dosa Batter, Mincing, etc.

- Fill the jar with the solids to be liquidised such as Tomatoes, Watermelon etc. and fit the jar onto the main unit
- Put the Dome Assembly onto the jar and lock clips till it fits properly. Put Dome Cap in to the place (Fig. 5)
- If needed, more water can be added by removing Dome Cap
- Now switch on the Mixer till you get finely blended Juices, Purees, etc.

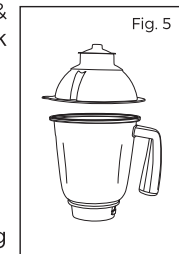

### Note:

- Always ensure that the Dome Lid and Dome Cap are in place before starting
- Use pulse control initially for better results
- Use the handle of the jar for pouring out the contents
- **DO NOT use this jar for Dry Grinding**

## WET/DRY GRINDING JAR

This jar (Fig. 6) can be used for grinding items like Turmeric, Coconut Chutney, Groundnut, Red Chilli, Sugar, Spinach etc.

- Fill the jar with the ingredients till maximum capacity of the jar and add some water as per the desired quantity (in case of wet grinding)
- Put the lid on the top of the jar, clamp it and fit the jar assembly onto the main unit
- Grind at a low speed for about 15 sec. and then move to higher speeds. Keep adding water till you achieve desired consistency for wet grinding
- For Dry Grinding, stop intermittently and use spatula to churn ingredients before starting to grind again

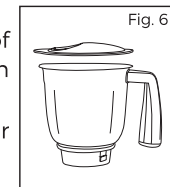

### Note:

- Always ensure that the lid is in place before starting
- Don't add all the water at a time. Instead of that add it with smaller quantities as and when required
- Always move gradually from lower to higher speeds
- Use the handle of the jar for pouring out the contents

## CHUTNEY JAR

This jar can be used to grind small quantities of Cumin, Coriander, Coconut, Green Chilli, Peeper, Garam Masala etc.

- Put the ingredients to be ground in the chutney jar
- Hold the lid (Fig. 7) and press it down firmly on the chutney jar, ensuring that the lid has locked in securely from all sides by its clips
- Place the chutney jar on the main unit locking the jar base by rotating it clockwise
- The substance to be ground should not be too large cut/break ingredients into smaller pieces

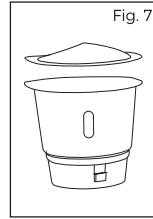

### Note:

- Do not add too much water while using this jar
- Do not run the mixer continuously as it tends to rob the ingredients of their flavour-thus short spurts would be preferable.
- While dry grinding, friction may heat up the jar, this is not abnormal

## BLADES AND THEIR FUNCTIONS

### (1) Hardened stainless steel universal grinding blade:

To be primarily used for wet as well as dry grinding. It can be also used for liquidising, whipping and grating functions.



### (2) Stainless steel liquidising blade:

For blending and liquidising.



### (3) Stainless steel chutney blade:

For grinding Chutney and small quantities of spices.



### (4) Stainless steel whipping blade:

For whipping Cream, Batter, Lassi, Milkshakes etc.



### (5) Stainless steel mincing blade:

For mincing meat



## HOW TO CARE FOR YOUR MIXER GRINDER

### CLEANING AFTER USE

**Caution:** Be sure to switch off your Mixer Grinder after use. Wait until the blades come to a halt before removing the lid or dome.

- After each use, it is highly desirable to wash and thoroughly clean the jar, blade and the lids
- Firstly remove the main plug from the wall socket. Gently detach the jar, from the main unit

- Open the lid & empty the contents
- To remove the blade assembly, hold the jar coupler from base and use Spatula to gently loosen/unscrew the plastic dome nut of the blade assembly in clockwise direction (Fig.8). The jar can be cleaned using some warm soapy water. Then rinse with a soft damp cloth. Do not keep the jar immersed in water
- Do not immerse the main unit in water. The main unit can be cleaned by using a damp cloth
- Cleaning is easy and best done immediately after use
- Store the Mixer Grinder in a clean and dry place

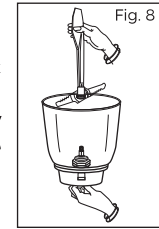

## OVERLOAD PROTECTOR (OLP)

- The OLP is designed to protect your motor from over heating and burning
- When the jar is over loaded or the liquid is too viscous, the OLP trips and the motor stops automatically
- When this happens, reduce the quantity of the material being ground or add some water
- To restart, press the OLP button located at the bottom on the mixer base (Fig. 9) after 2-3 minutes
- Wait for a while and then start your Mixer Grinder again

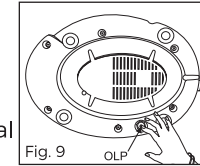

## TECHNICAL SPECIFICATION

Model No.	MIXER GRINDER, Sin750L
<b>Specification</b>	
Power	750 W
Voltage	230V AC, 50Hz
Motor Insulation	Class - B
Motor Speed (No Load)	20000 RPM (Approx.)
Speed Control	3 Speed and Pulse
<b>Material</b>	
Housing	High quality ABS Plastic
Liquidising Jar	Stainless Steel
Dry Jar	Stainless Steel
Chutney Jar	Stainless Steel
<b>Capacity</b>	
Liquidising Jar	1.5 L
Dry Jar	1.0 L
Chutney Jar	0.3 L
Main Cord	PVC, 1.50m long
Plug	6A, 3 Pin Plug